

FOR LEASE

COMMERCIAL FLEX BUILDING

1714 COMMERCE CT
COLUMBIA, MO 65202

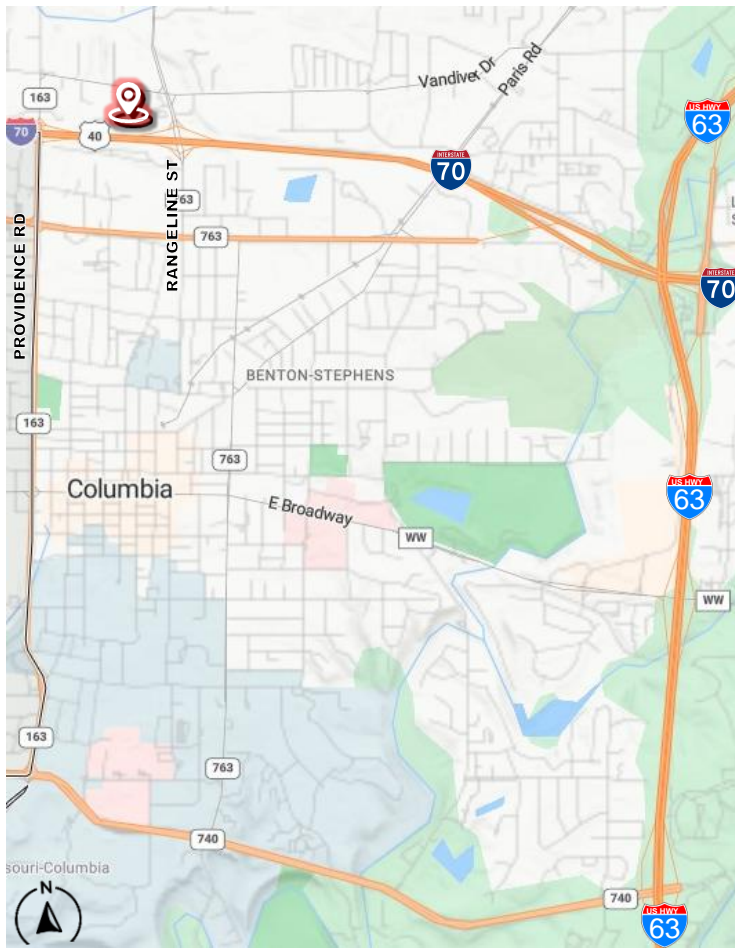

INDUSTRIAL BUILDING *AVAILABLE JUNE 2025

INDUSTRIAL | OFFICE | RETAIL

LOCATION: 1714 Commerce Ct, Columbia, MO 65202

BUILDING SIZE: 10,000-26,000 SF

-Warehouse: 20,297 SF

-Office: 3,220 SF

-Freezer: 2,483 SF

SITE SIZE: 2.41 ACRES

ZONING: Industrial [Industrial, Office, Retail]

PROPERTY HIGHLIGHTS:

- Clear Height: 20'-24'
- (6) Dock Doors & (3) Drive Door
- Quick Access To: I-70, HWY 63, Vandiver Dr, Rangeline St, & Providence Rd.
- Turnkey Opportunity: Equipped with robust Mechanical, Electrical, and Plumbing (MEP) systems designed to support heavy production & processing operations. Additionally equipped with a 2,483 SF freezer.
- Adjacent To: Rob's Auto Works, Starbucks, Dobbs Tire & Auto Center, & Joe Machens Toyota.

LEASE RATE: \$21,667/month

LEASE TYPE: NNN

573.875.5151

broker@silvertreeco.com

www.silvertreerealtyco.com



FLOOR PLAN

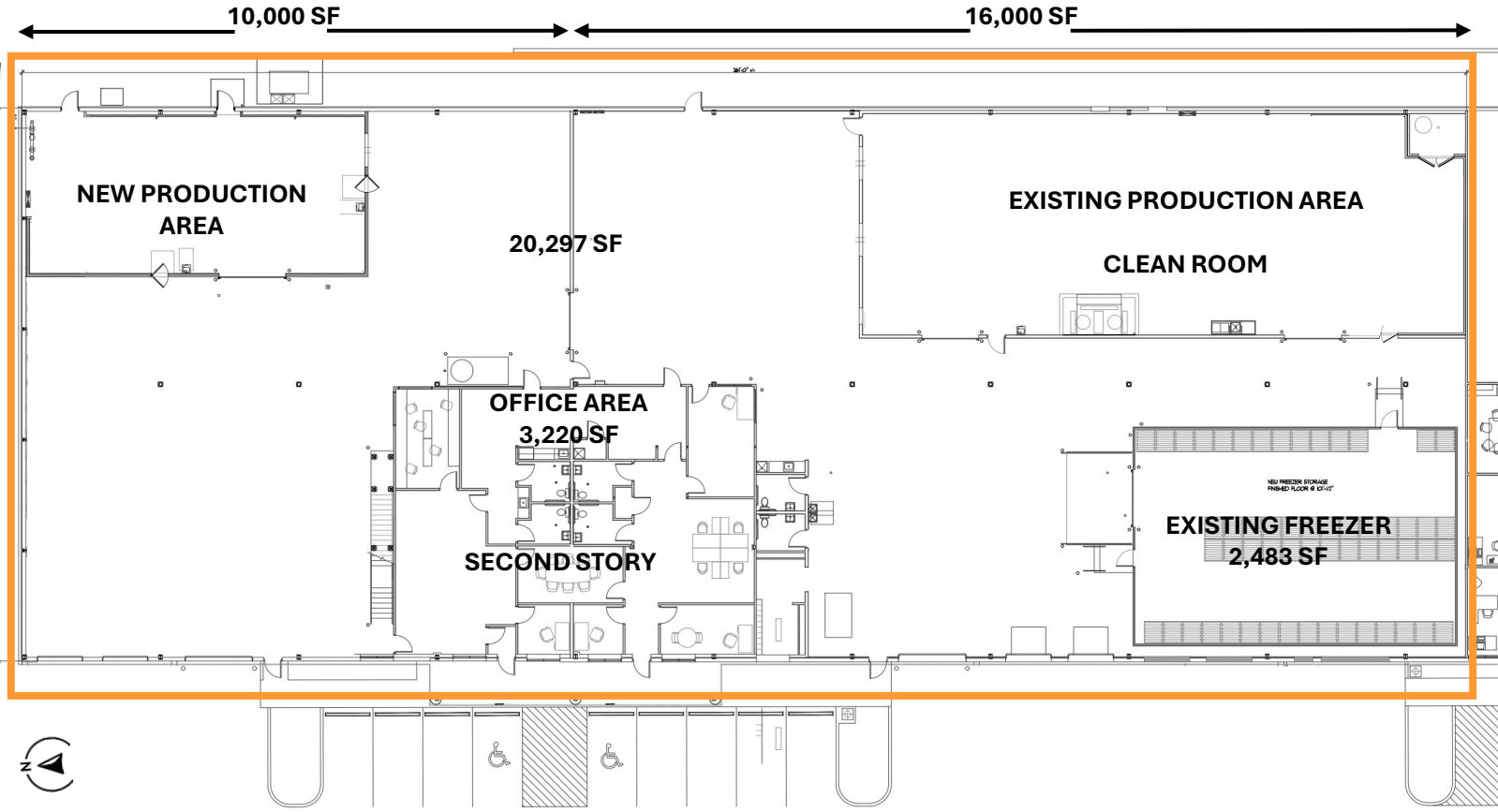

1714 COMMERCE CT, COLUMBIA, MO 65202
26,000 SF
2.41 AC