

Available

Concorde Office & Industrial Plaza | Lot 27 | Maguire Blvd, Columbia MO 65201



Concorde Office & Industrial Plaza

- **3.90 Acres For Sale**
- **Zoned: M-C**
- Located in Columbia's premier office and industrial park.
- Convenient access to **Hwy 63 & I-70**
- Within walking distance to the newly developed **Cross Creek Retail Center**, hosting convenient dining such as Taco Bell, Zaxby's, Break Time, etc.
- **Sale Price: \$849,420.00**

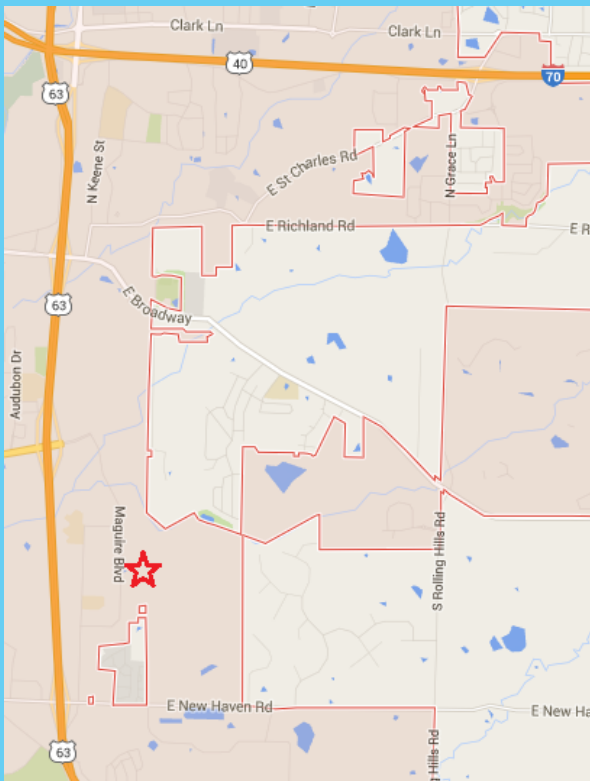

Wilson Burchfield | SilverTree Realty

Cell 573.356.6412 | Office 573.875.5151

Email wburchfield@silvertreeco.com